

JOB NAME:	
CONTRACTOR:	DATE:

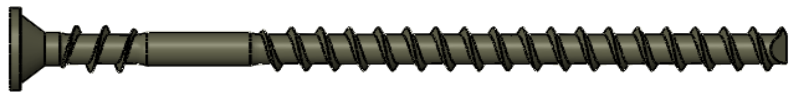

CAMO® BUGLE HEAD (RAKE TIP) SCREW

Size Range: #9
Head Type: Bugle
Drive Type: T20 Star
Point Type: Rake



COLLATED FOR CAMO DRIVE USE ONLY

APPLICATION Secures decking to wood substructure
 For indoor or outdoor applications
 Collated for use with CAMO DRIVE

FEATURES Compatible with chemically treated lumber
 Rake tip removes board material as it bores in, reducing risk of splitting
 Bugle Head design increases pull-down strength
 Reverse upper thread pulls the board tight to the joist and provides a clean finish at entry point

COATINGS Proprietary ProTech coating is designed to work with chemically treated lumber
 ProTech coating is available in tan or green for this product

INSTALLATION Not recommended for use with impact drivers

CAUTION Not to be used for structural applications
 Not designed for use in aluminum, vinyl, stone, or rubber deck board products
 Not designed for use with steel or other metal substructure components
 No warranty is provided when the product is used in connection with incorrect applications
 Read manufacturers' installation instructions for deck board products



DIMENSIONS

	Head Dia.	Overall Length	Major Thread Dia.	Minor Thread Dia.	Shank Dia.	Thread Length
	A	L	D1	D2	S	T
#9 x 3 in	∅ 0.200 in	3.00 in	∅ 0.157 in	∅ 0.106 in	∅ 0.114 in	1.03 in

PRODUCT AVAILABLE

ProTech SKU Green	ProTech SKU Tan	ProTech SKU Red	Size x Length	Box Count QTY	Master Pack
0395040	0395042	0395047	#9 x 3 in	1000 ct	1
(2) T20 Bits Included in Every 1000 ct Box					