

# CAMO CLIPS

## INSTALLATION GUIDE

FOR STARTER, EDGE, WEDGE AND WEDGE METAL CLIPS

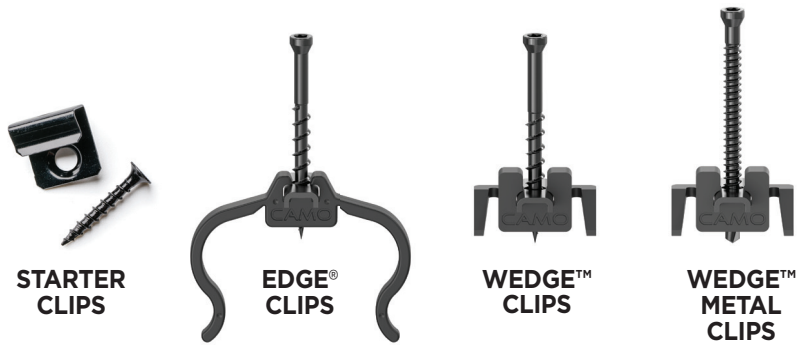

### HOW MANY CLIPS DO YOU NEED FOR YOUR DECK?

JOIST SPACING (ON CENTER)	NUMBER OF CLIPS NEEDED		
	50 SQ. FT.	100 SQ. FT.	200 SQ. FT.
12 in.	117	233	466
16 in.	90	180	360

### TOOLS NEEDED

**Required**  
**Drill** - We recommend an 18v or greater cordless driver drill with adjustable clutch setting

**Recommended**  
**CAMO ClipDRIVE™** - attaches to your drill for stand-up clip fastening  
**CAMO LEVER®** - locks in rows of boards and clips

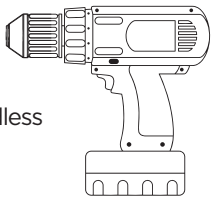

### Pro Tips for the Best Deck Install Experience

- Always review and follow your deck board manufacturer's gap spacing and on-center span requirements for deck board installation.
- Use proper personal protective equipment for every job.
- Before installing deck boards on wood framing, apply CAMO Deck Tape to top of joists, rim joists, ledger boards, deck blocking, and under joist hangers. Deck Tape creates a waterproof membrane to protect the deck framing from moisture and rot.
- Double (sister) joists are required at all butt joints to accommodate one clip on each joist. See BUTT JOINT instructions on page 3.
- You must have unobstructed airflow under 50% of the deck to allow for sufficient cross-ventilation from one side to the other.
- Your deck should **not** be installed directly over any solid surface such as concrete.
- If installing deck boards on metal framing, note that WEDGEMETAL™ Clips are designed for use on 14-18 gauge metal joists only.

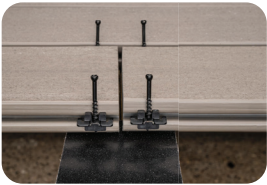

#### Installation Guidelines for Specific Deck Board Materials

- Grooved PVC Deck Boards
  - Because of the potential for linear expansion and contraction from temperature variance, use shorter board lengths where possible.
  - Use a breaker board design to shorten board runs.
  - End-to-Side board spacing (Where deck board end meets fixed breaker or picture frame board) *See chart below*

END-TO-SIDE BOARD SPACING BY INSTALLATION TEMPERATURE	
70 Degrees and below	71 Degrees and above
3/16" (5mm)	1/8" (3.2mm)

- For board runs 16' and longer, face fasten at the midpoint and at both ends of the boards with color matched stainless steel composite screws. (plug systems are acceptable)
- Boards should be kept at ambient temperature and shaded from direct sun prior to cutting and immediate fastening
- Grooved Hardwood Deck Boards
  - Boards should acclimate on-site for at least 7 days before installation.
  - Use the sticker method while acclimating to allow proper airflow.

### Before You Begin Drill Setup for Edge® and Wedge™ and WedgeMetal™ Clips



1 Insert the included T-15 driver bit into your drill. Do not use an impact driver.



2 If your drill has a drill and clutch mode, set it to clutch mode. Turn down torque to the lowest setting. Increase as necessary

# STARTER CLIPS

To secure first and last deck boards



LEARN MORE ABOUT CAMO STARTER CLIPS



## OPTIONAL INSTALLATION

Second hole in the clip is for possible use as an L-bracket when desired.

- **Never** use the included screw for fastening directly to a deck board. It is intended only for fastening to the joist.

- If attaching to a deck board, choose a screw length that will not penetrate completely through the board.

# EDGE CLIPS



LEARN MORE ABOUT CAMO EDGE CLIPS

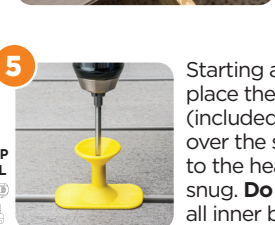
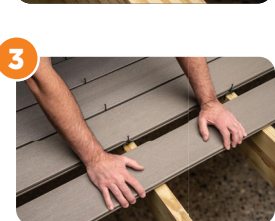

## OPTIONAL INSTALLATION METHOD



To fasten with ClipDRIVE™ - starting at the outermost board, put the nose over the screw head and drive at full RPM while applying downward pressure. Repeat until all inner boards are fastened.

# WEDGE CLIPS™™



For use with wood joists

**METAL**

For use with 14-18 GA metal joists

LEARN MORE ABOUT CAMO WEDGE AND WEDGEMETAL CLIPS

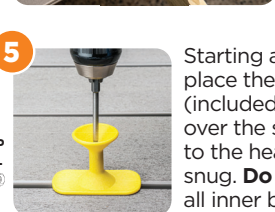
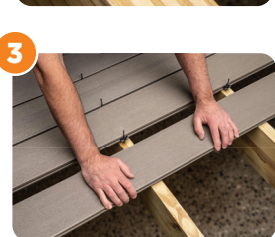

## OPTIONAL INSTALLATION METHOD



To fasten with ClipDRIVE™ - starting at the outermost board, put the nose over the screw head and drive at full RPM while applying downward pressure. Repeat until all inner boards are fastened.



## BUTT-JOINTS

### ALWAYS INSTALL A DOUBLE JOIST AT THE BUTT JOINTS.

Use a separate clip to secure each board end. Please follow your deck board manufacturer's instructions for end-to-end board gapping distance to allow for expansion and contraction at this joint.

**4 CLIPS**  
ARE NEEDED  
FOR EACH  
BUTT JOINT.



## EDGE CLIPS

1



You will need 4 clips for each butt joint. Remove the legs of the EDGE Clips so that they can sit side-by-side on the double joists.

2



With boards positioned correctly, place the clips in the groove, centered on joists on both sides of the boards. Partially fasten the screws to hold them in place until next board is set, then fully fasten the screws.

## WEDGE & WEDGEMETAL CLIPS

1



Place 4 clips centered on joist on both sides of the boards.

2



Place the next board up against the clips then fasten the screws.

## REPLACING DECK BOARDS

1



Back out all of the screws from the joist on both sides of the board.

2



Pull up on the board to easily remove it.

3



Clean away any clips remaining on the joists and lay the new deck board in position without any clips in place.

4



Count the number of clips needed and snap off the legs on each EDGE Clip, if using.

5

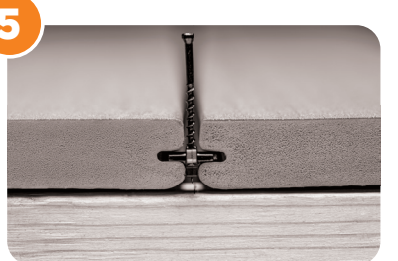

Slide the clips (screws and gussets) down the groove, positioning one over each joist on both sides of the board.

6



Fasten clips securely in place using the NEVER-MISS® Guide.



# CAMO® HELPS YOU BUILD BETTER.



## CAMO CLIPDRIVE™

**STAND UP FASTENING TOOL FOR CAMO®  
UNIVERSAL DECK CLIPS**

- Install grooved decking up to 5X faster
- For use with CAMO Universal Deck Clips on leading grooved deck boards
- Attaches to your drill, features an adjustable handle, and has a weighted nose for easy screw targeting
- Ergonomically designed to be easy on the body and reduce fatigue on the job
- CAMO Universal Deck Clips and the ClipDRIVE are backed by a CAMO Warranty



## CAMO BLOCK®

**THE BETTER FLOATING FOUNDATION**

- Lightweight - 18x lighter than cement footings - each BLOCK only weighs 2.16lbs.
- Load rated to support 1800 lbs, making them stronger than cement footings
- Made from recycled material and can be recycled when it's at the end of its life
- Comes with a 30-year warranty, will not chip, crack, or corrode, and is vented to prevent water build-up, rot, and mold.
- Easy to install and transport



## CAMO LEVER®

**BOARD BENDING AND LOCKING TOOL**

- Speeds up grooved deck installs—locks-in rows of boards and clips before fastening
- Strong enough to straighten any warped board
- Easily adjusts to wood and metal joists 1-½–3 in. wide for jobsite versatility
- Multi-directional lever locks in one turn



## CAMO JOIST + LEDGER DECK TAPE

- Self Adhesive butyl tape creates a waterproof membrane to protect wood deck framing
- Self seals around fasteners, blocking the pathway of water into wood
- Extends the life of your deck
- Securely bonds to wood framing
- One roll covers approximately 75 square feet of deck framing.

